

## IP67Pro Constant current single color LED Strip 120LEDs/ DC24V



### ◆ Product Description:

use solid extrusion technology for sealing thoroughly, achieving a waterproof rating of IP67Pro. It adopts triode constant current, can be super-long connection, the brightness with in 15M is consistent even if one end is powered, suitable for large projects DC24V constant current, cuttable every 6LEDs/50mm The CCT of white can be customized as warm white or pure white or cool white



### ◆ Product Datasheet

Product Number	S012120BC1HZ(N1506)
Operating Voltage	DC24V
Power/m	10W
SMD Type	SMD 2835
LED Qty/m	120
Cutting Length	50mm / 6LED
Color	W:3000K/4000K/6500K
Luminance/m	W:1198lm
Ra	≥ 90
Beam Angle	120°
Size (mm)	5000x12mm
IP Rate	IP67Pro
Operation Temperature	- 25 ~ 60°C

#### Remarks:

- 1.The above parameters were tested according to integrating sphere TM-30-15.
- 2.The output data is based on IP20 and one merter.
- 3.The data such as power etc, ±15% tolerance is normal.
- 4.IP protection process causes changes in size, CCT and luminous flux.

### ◆ Luminous effect diagram

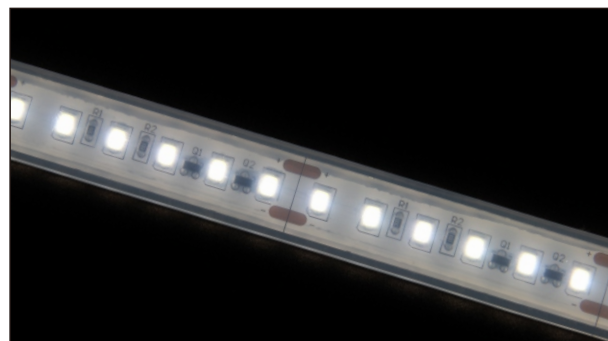

## Outline Dimension (unit:mm)

Mold injection end cap -Straight outlet

DC24V

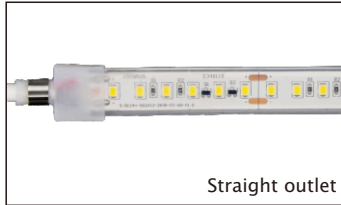
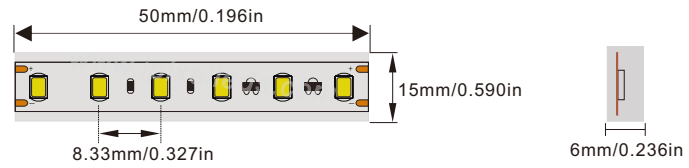

24V  
GND

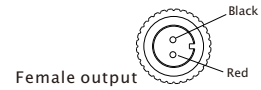
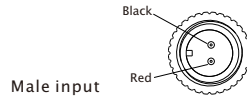
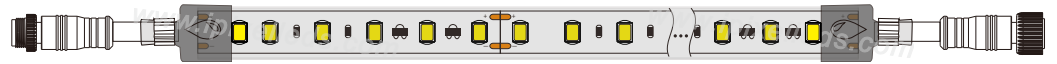

24V  
GND

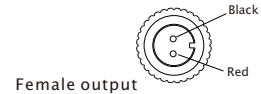
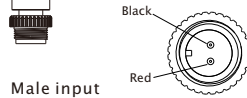
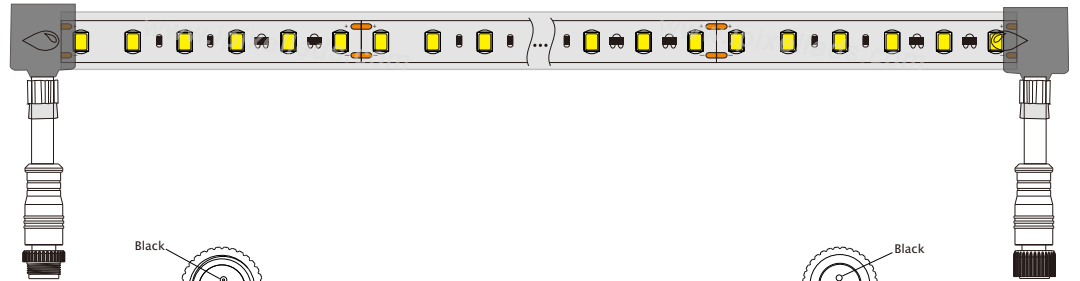

24V  
GND

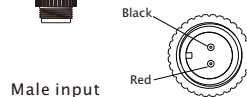
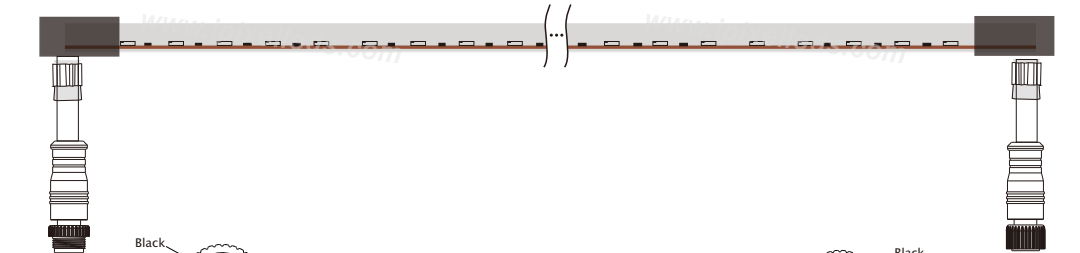

24V  
GND

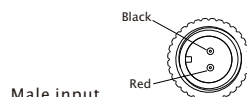

## ◆ Wiring diagram

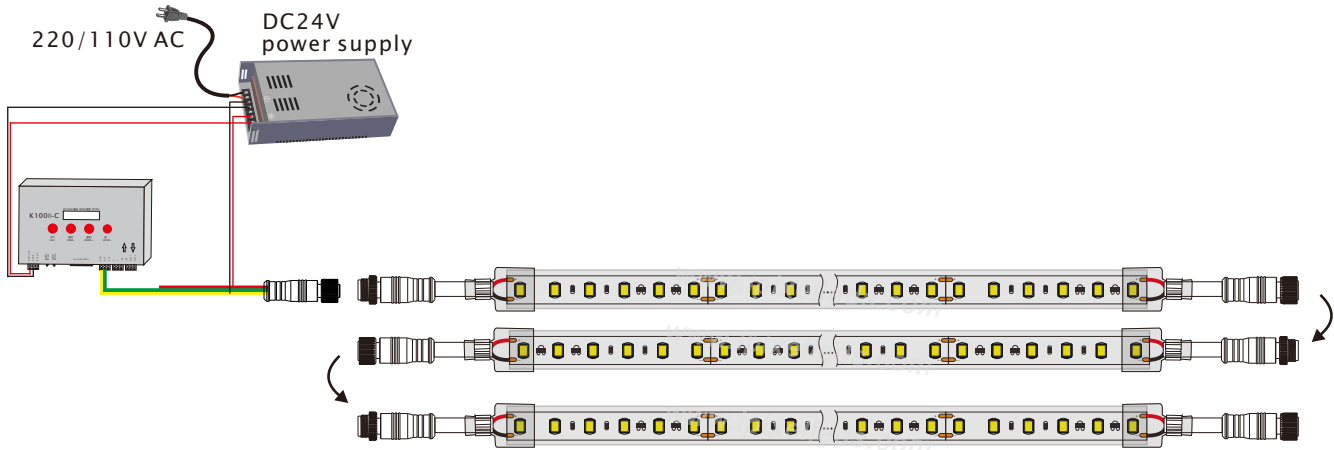

## ◆ Product Accessories

Name	Describe	Picture	Net weight (g)	Product size (mm)	Remarks
Alum LED Profile	Pre installation slot		146g	L1000xW19.4xH11.6	Aluminum
Female Connector	2Pin Cable connector		23g	φ 15xL200	Silicone
Male Connector	2PIN Connector		18g	φ 15xL200	Silicone
Connector	2PIN IP68 Connector		/	/	Extension cord
Power supply	power supply		1.23Kg	L220.4xW130xH48	/
Controller	controller/dimmer		0.13Kg	L85xW40xH7	/

## ◆ Schematic diagram of maximum bending prevention



Note: The parameters are subject to change without notice!

## Waterproof connector installation diagram

### Correct installation steps

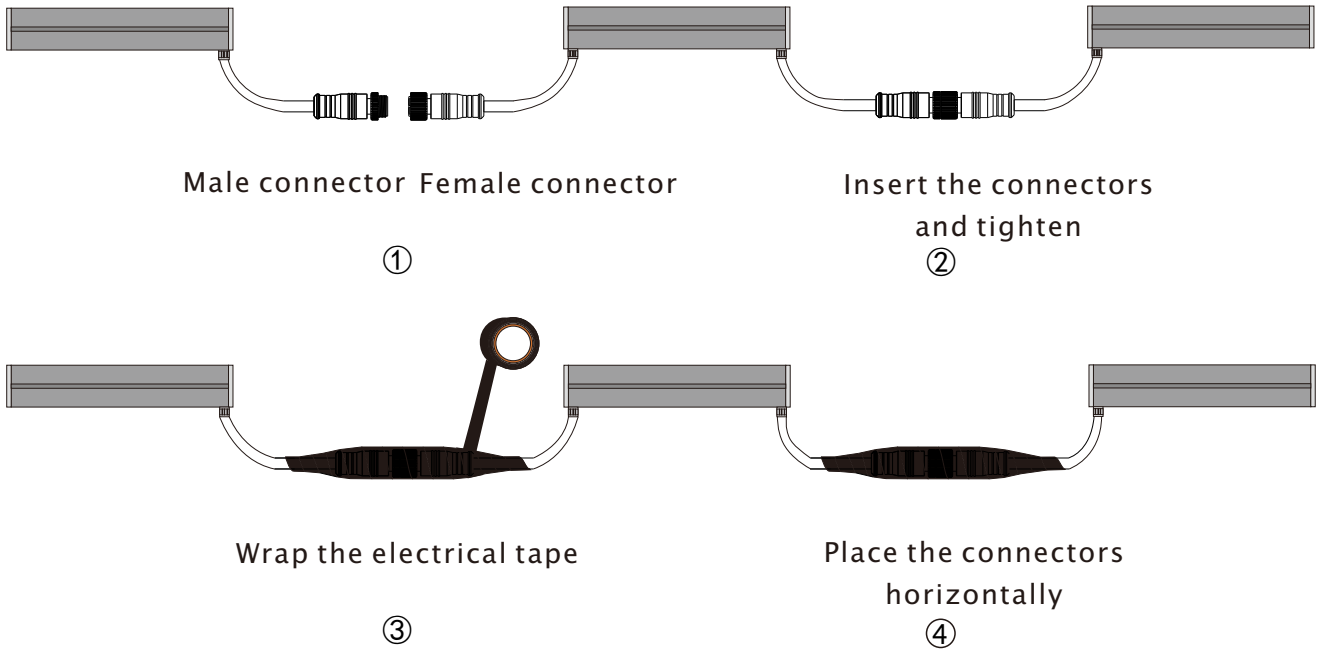

### Wrong installation ways

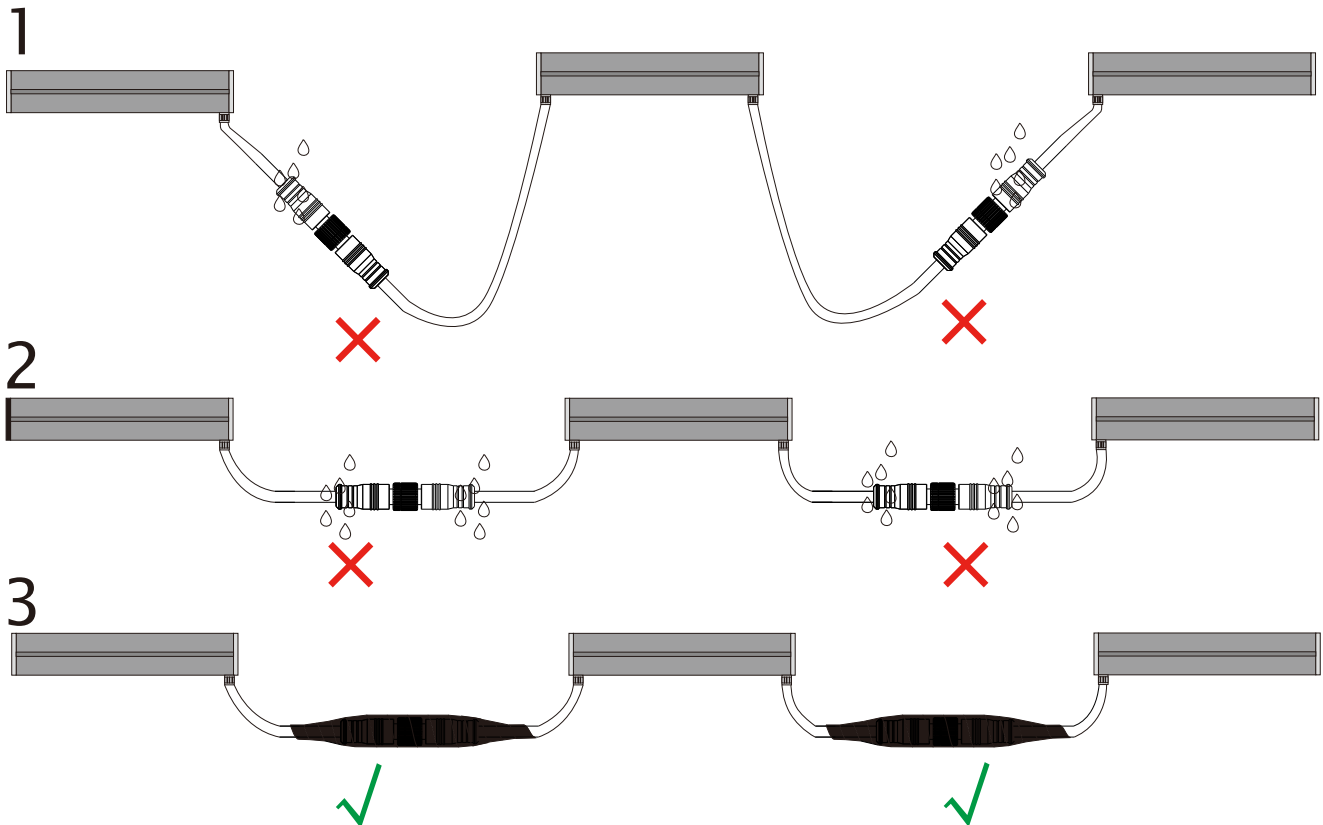

Tips: Figures 1 and 2 are in harsh environments where water may enter. Please follow Figure 3 and wrap the electrical tape or waterproof tape firmly during the construction process firmly

A1.25-03-03